

Milling

**ON EDGE MILLING
PARALLELOGRAMS
SQUARE SHOULDER MILLING
GEAR BLANK
WEDGE BLANK PCD
HEXAGONS
OCTOGONS
PENTAGONS
ROUND
SQUARE
TRIANGLE**

Positive On Edge Milling With Hole and Chamfers

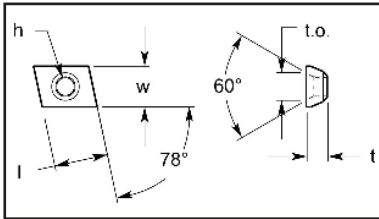

Part No.	Dimensional Specifications				
	t	w	l	h	t.o.
CDR322L	.160/.168	.385/.395	.510/.522	.162/.174	.257/.269
CDR322R	.160/.168	.385/.395	.510/.522	.162/.174	.257/.269
CDR323L	.200/.208	.385/.395	.510/.522	.162/.174	.257/.269
CDR323R	.200/.208	.385/.395	.510/.522	.162/.174	.257/.269

On Edge Milling With Hole • variable thickness quoted on request

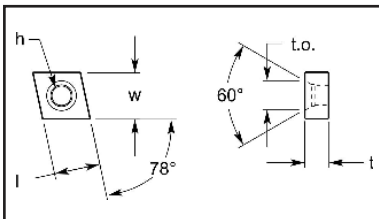

Part No.	Dimensional Specifications				
	t	w	l	h	t.o.
CDR313L32-NEG	.198/.206	.391/.401	.391/.401	.160/.170	.245/.255

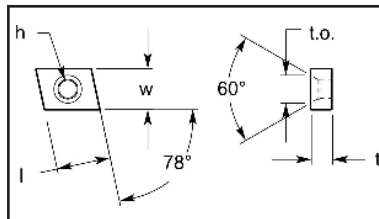

• variable thickness quoted on request

Part No.	Dimensional Specifications				
	t	w	l	h	t.o.
CDR322L-NEG	.160/.168	.385/.395	.510/.522	.162/.174	.257/.269
CDR322R-NEG	.160/.168	.385/.395	.510/.522	.162/.174	.257/.269
CDR323L-NEG	.200/.208	.385/.395	.510/.522	.162/.174	.257/.269
CDR323R-NEG	.200/.208	.385/.395	.510/.522	.162/.174	.257/.269
CDR324L25-NEG	.260/.268	.385/.395	.510/.522	.162/.174	.257/.269
CDR324R25-NEG	.260/.268	.385/.395	.510/.522	.162/.174	.257/.269

Positive On Edge Milling With Hole And Chamfers

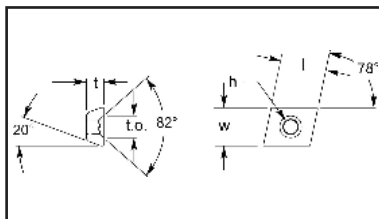

Left hand shown

Part No.	Dimensional Specifications				
	t	w	l	h	t.o.
CDR424L30	.263/.271	.578/.586	.702/.712	.207/.219	.331/.337
CDR424R30	.263/.271	.578/.586	.702/.712	.207/.219	.331/.337

On Edge Milling

On Edge Milling With Hole • variable thickness quoted on request

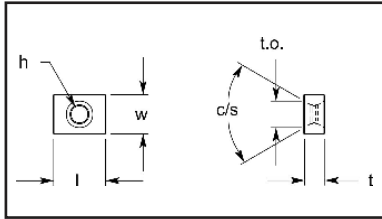

Part No.	Dimensional Specifications					
	t	w	l	h	t.o.	c/s
LNR313	.202/.207	.389/.395	.515/.525	.162/.174	.257/.269	60°
LNR314	.265/.270	.389/.395	.515/.525	.162/.174	.257/.269	60°
LNR323	.202/.207	.389/.395	.640/.650	.162/.174	.257/.269	60°
LNR323-01	.202/.207	.389/.395	.640/.650	.162/.174	.257/.269	60°
LNR323-02	.202/.207	.389/.395	.640/.650	.162/.174	.257/.269	60°
LNR323-03	.232/.240	.389/.395	.640/.650	.162/.174	.257/.269	60°
LNR323-24	.232/.240	.389/.395	.640/.650	.162/.174	.257/.269	60°
LNR323MOD	.202/.207	.389/.395	.639/.645	.197/.209	.322/.334	82°
LNR324	.265/.270	.389/.395	.640/.650	.162/.174	.257/.269	60°
LNR324-01	.265/.270	.389/.395	.640/.650	.162/.174	.257/.269	60°
LNR325	.322/.330	.389/.395	.640/.650	.162/.174	.257/.269	60°
LNR423	.202/.207	.515/.525	.640/.650	.207/.219	.328/.340	82°
LNR423-20	.202/.207	.515/.525	.640/.650	.207/.219	.328/.340	82°
LNR424	.265/.270	.515/.525	.640/.650	.207/.219	.328/.340	82°
LNR425	.324/.330	.515/.525	.640/.650	.207/.219	.328/.340	82°
LNR425-MOD	.324/.330	.515/.525	.640/.650	.207/.219	.306/.318	82°
LNR433	.202/.207	.515/.525	.765/.775	.207/.219	.328/.340	82°
LNR433-16	.198/.206	.579/.585	.765/.775	.207/.219	.328/.340	82°
LNR434-02	.265/.270	.579/.585	.765/.775	.207/.219	.328/.340	82°
LNR434-05	.265/.270	.579/.585	.765/.775	.207/.219	.328/.340	82°
LNR434-20	.265/.270	.515/.525	.765/.775	.207/.219	.328/.340	82°
LNR435	.322/.330	.515/.525	.765/.775	.207/.219	.328/.340	82°
LNR436	.385/.393	.579/.585	.765/.775	.207/.219	.328/.340	82°
LNR443-01	.202/.207	.579/.585	1.020/1.040	.207/.219	.328/.340	82°
LNR443-20	.202/.207	.515/.525	1.020/1.040	.207/.219	.328/.340	82°
LNR444	.265/.270	.515/.525	1.020/1.040	.207/.219	.328/.340	82°
LNR445	.327/.322	.515/.525	1.020/1.040	.207/.219	.328/.340	82°
LNR445-.250RAD	.328/.333	.577/.587	1.020/1.040	.207/.219	.328/.340	82°
LNRQ3.524.177H	.265/.270	.450/.456	.516/.524	.174/.180	.233/.239	40°
LNRQ42.54.220H	.257/.261	.512/.530	.642/.662	.216/.224	.291/.295	40°
LNRV32.53	.203/.208	.390/.395	.640/.645	.165/.171	.257/.263	60°

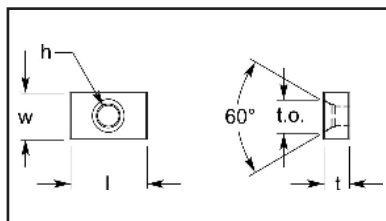

• variable thickness quoted on request

Part No.	Dimensional Specifications				
	t	w	l	h	t.o.
LNRW-200X375X625	.210/.218	.390/.395	.640/.645	.162/.174	.260/.266
LNRW125X375X625	.135/.143	.389/.395	.640/.650	.163/.173	.258/.268
LNRW14X375X625DU	.151/.157	.389/.395	.652/.662	.162/.174	.260/.266
LNRW170X375X625	.181/.187	.389/.395	.640/.645	.165/.171	.260/.266
LNRW222X375X625	.233/.239	.389/.395	.640/.650	.165/.171	.260/.266
LNRW32.530	.198/.203	.390/.395	.640/.645	.165/.171	.257/.263



On Edge Milling With Hole

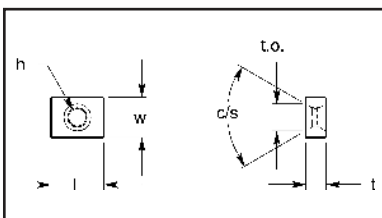

Part No.	Dimensional Specifications				
	t	w	l	h	t.o.
LNRW187X312X7750	.197/.205	.327/.337	.768/.778	.165/.171	.260/.266

TURNING

Ultra-met®

carbide technologies

FABRICATOR & TOOLMAKER
Capabilities Catalog

On Edge Milling

MILLING

Positive On Edge Milling With ISO Style Hole

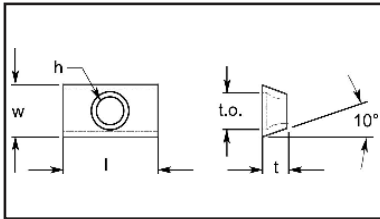

Part No.	Dimensional Specifications					
	t	w	l	h	t.o.	c/s
21.000473.100.2	.260/.268	.517/.523	.891/.897	.173/.177	.234/.238	iso
LNRW21.001593	.260/.268	.517/.523	.986/.992	.173/.177	.234/.238	iso

GROOVING

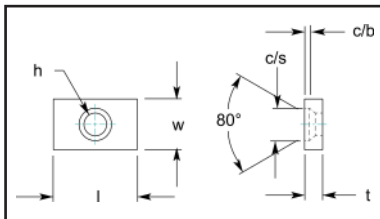
 On Edge Milling

Part No.	Dimensional Specifications					
	t	w	l	h	c/s	c/b
LNRB32.52-UM	.135/.143	.387/.393	.640/.650	.165/.185	.240/.260	.033/.041

DRILLING

THREADING

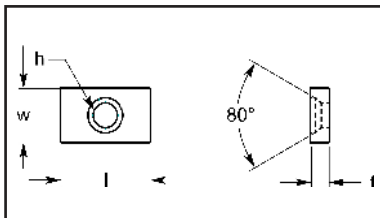
 On Edge Milling

Part No.	Dimensional Specifications			
	t	w	l	h
059X297X472-BLK	.075/.083	.294/.300	.468/.476	.151/.157

BRAZED
BLANKSRECTANGLES
STB

On Edge Milling With Hole

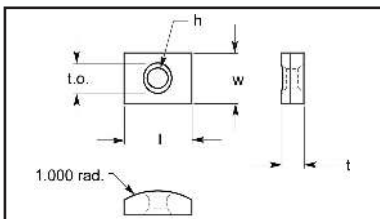

Part No.	Dimensional Specifications				
	t	w	l	h	t.o.
LNR434-1.000RAD	.265/.270	.579/.585	.765/.775	.207/.219	.349/.361

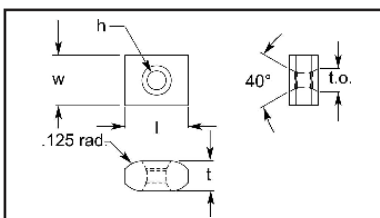
WOOD
WORKINGOIL & GAS
MINING

Part No.	Dimensional Specifications					
	t	w	l	h	t.o.	r
D-21-1457-00	.325/.331	.445/.455	.512/.522	.161/.167	.249/.259	.081/.091
LNRQ11.14.06.00	.267/.273	.449/.457	.566/.576	.174/.180	.233/.239	0.125

MISC.
SHAPES

On Edge Milling

On Edge Milling With Hole

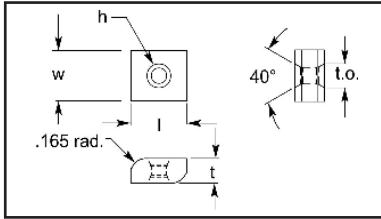

Part No.	Dimensional Specifications				
	t	w	l	h	t.o.
LNRQ13.15.06.00	.267/.273	.548/.556	.610/.620	.167/.180	.233/.239

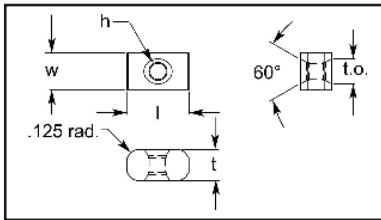

Part No.	Dimensional Specifications				
	t	w	l	h	t.o.
LNR325.125R	.322/.330	.389/.395	.640/.650	.164/.172	.259/.267

On Edge Milling

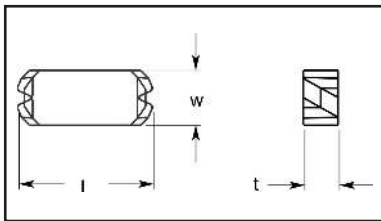

Part No.	Dimensional Specifications		
	t	w	l
LNRX1806AZL11	.265/.275	.408/.418	.972/.982
LNRX1806AZR11	.265/.275	.408/.418	.972/.982

On Edge Milling With Hole

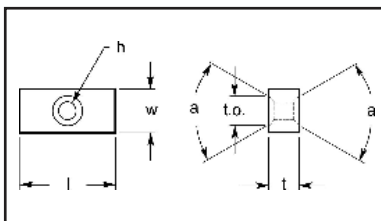

Part No.	Dimensional Specifications					
	t	w	l	h	t.o.	a
1035AS	.327/.337	.765/.775	1.270/1.290	.216/.221	.439/.445	82°
22-000060-100-1	.257/.261	.512/.530	.642/.662	.216/.224	.291/.295	40°
9ZE2448-1	.329/.335	.515/.525	.765/.775	.201/.206	.350/.358	82°
DWG#M8932C	.198/.206	.389/.395	.640/.650	.201/.205	.306/.316	82°
DWG#M8932-DET#3A	.185/.191	.389/.395	.640/.650	.201/.205	.306/.316	82°
DWG#T604207	.202/.207	.390/.395	.642/.648	.167/.171	.297/.313	82°
DWG#U-4682	.265/.270	.450/.456	.516/.524	.174/.180	.233/.239	40°
SCBI353A	.202/.207	.390/.400	.644/.654	.202/.210	.323/.333	82°
SK#2329-7	.322/.330	.515/.525	.640/.650	.207/.219	.331/.337	82°
SK#DT-30	.198/.206	.389/.395	.640/.650	.200/.206	.325/.331	82°
TD-11950-2	.257/.261	.512/.530	.642/.662	.216/.224	.291/.295	40°

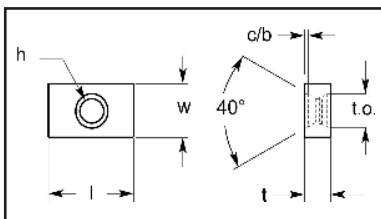

Part No.	Dimensional Specifications					
	t	w	l	h	t.o.	c/b
M56288-07	.305/.311	.447/.453	.514/.520	.172/.182	.223/.233	.053/.059
M56288-25	.309/.315	.488/.498	.725/.735	.172/.182	.224/.234	.044/.054
M56288-26	.313/.319	.453/.463	.571/.581	.172/.182	.224/.234	.049/.054

TURNING

Ultra-met[®]

carbide technologies

FABRICATOR & TOOLMAKER
Capabilities Catalog

On Edge Milling

MILLING

On Edge Milling With ISO Style Hole

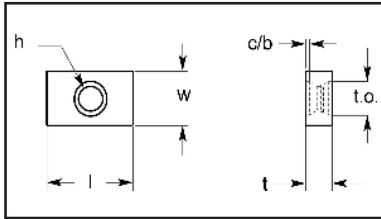

Part No.	Dimensional Specifications					
	t	w	l	h	t.o.	c/b
A-102-0703	.263/.271	.389/.395	.640/.650	.168/.178	.234/.244	.030
DWG#E-17099-020BLANK	.198/.206	.389/.395	.640/.650	.170/.176	.236/.242	.030

GROOVING

On Edge Milling With Hole And Countersink

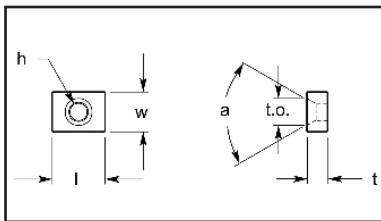

Part No.	Dimensional Specifications					
	t	w	l	h	t.o.	a
MTB8761-31B	.135/.143	.389/.395	.640/.650	.163/.173	.258/.268	60°
U-4150-NEG	.200/.206	.389/.395	.515/.525	.158/.162	.237/.243	50°

DRILLING

THREADING

Parallelograms

Parallelogram

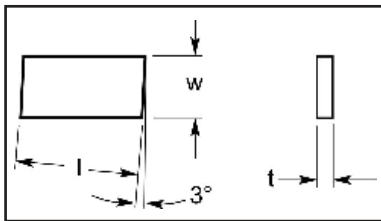

Part No.	Dimensional Specifications		
	t	w	l
UBCBP15"0"-NEG	.140/.145	.517/.523	1.028/1.035

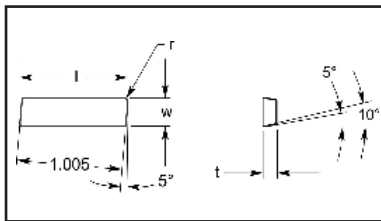
BRAZED
BLANKSRECTANGLES
STB

Part No.	Dimensional Specifications			
	t	w	l	r
UABC2442	.136/.142	.263/.269	1.020/1.030	1/32
UABC2448	.136/.142	.263/.269	1.006/1.016	1/8

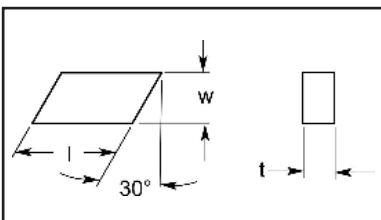
WOOD
WORKINGOIL & GAS
MINING

Part No.	Dimensional Specifications		
	t	w	l
OSP-5	.198/.206	.425/.431	.640/.650
OSP-6	.229/.237	.425/.431	.642/.648
UOSP5	.202/.207	.428/.433	.640/.645

MISC.
SHAPES

Parallelograms

Parallelogram

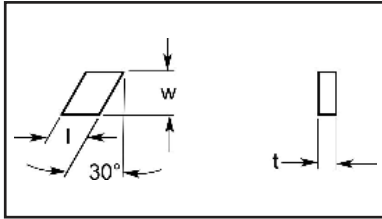

Part No.	Dimensional Specifications		
	t	w	l
DWG#U-5616	.105/.111	.200/.206	.262/.268

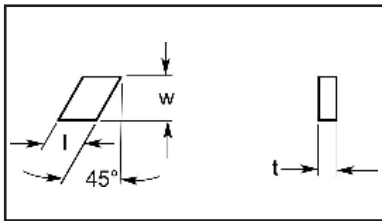

Part No.	Dimensional Specifications		
	t	w	l
DWG#U-5617	.105/.111	.200/.206	.262/.268

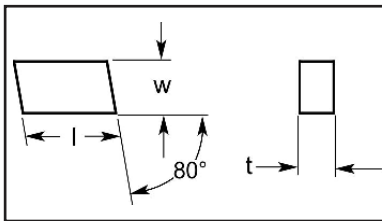

Part No.	Dimensional Specifications		
	t	w	l
UM-1376	.262/.268	.392/.398	.702/.710

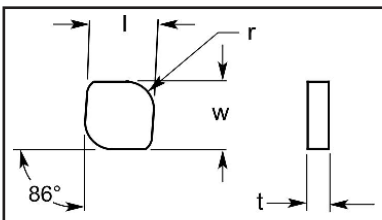

Part No.	Dimensional Specifications			
	t	w	l	r
#2558-5972	.327/.332	1.020/1.030	1.028/1.038	16/39

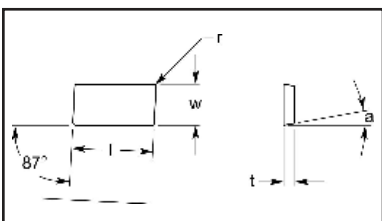

Part No.	Dimensional Specifications				
	t	w	l	r	a
BCBP15-NEG	.140/.145	.517/.523	1.025/1.035	0	0°
BCBP15RH	.140/.145	.517/.523	1.020/1.035	3/64	10°

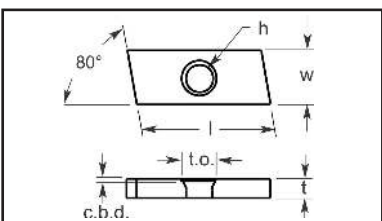

Part No.	Dimensional Specifications					
	t	w	l	h	t.o.	c/b
SK-1783-EMP	.100/.106	.276/.284	.685/.695	.131/.137	.174/.180	.009/.015

TURNING

Ultra-met[®]

carbide technologies

FABRICATOR & TOOLMAKER
Capabilities Catalog

Parallelograms

MILLING

Parallelogram

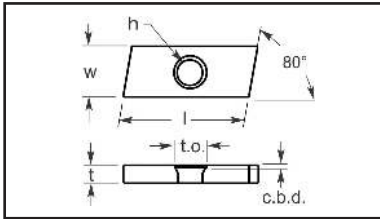

Part No.	Dimensional Specifications					
	t	w	l	h	t.o.	c/b
SK-1783-L-EMP	.100/.106	.276/.284	.685/.695	.131/.137	.174/.180	.009/.015

GROOVING

Parallelogram Milling Blank With ISO Style Hole

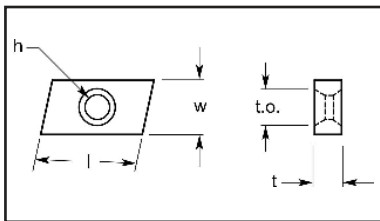

Part No.	Dimensional Specifications				
	t	w	l	h	t.o.
CNR343-02	.260/.268	.448/.458	1.152/1.164	.163/.173	.251/.261

DRILLING

THREADING



Parallelogram

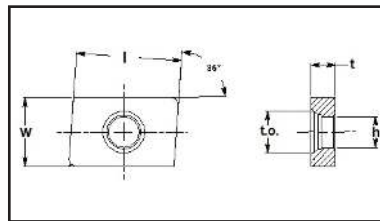

Part No.	Dimensional Specifications				
	t	w	l	h	t.o.
CNDR322	.135/.145	.387/.397	.601/.611	.173/.183	.244/.254

BRAZED
BLANKSRECTANGLES
STB

Square Shoulder

Square Shoulder Milling Blank With Chipbreaker And ISO Style Hole

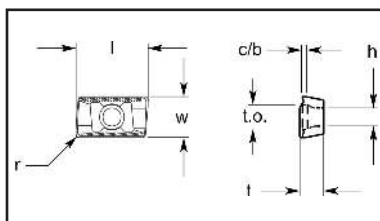

Part No.	Dimensional Specifications						
	t	w	l	h	t.o.	c/b	r
APRX1604PDR-ME12	.227/.233	.389/.395	.690/.696	.170/.176	.233/.239	.047/.053	.031

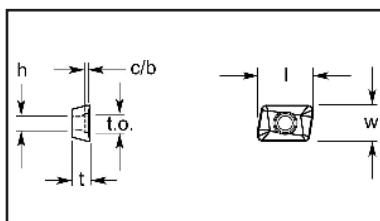
WOOD
WORKINGOIL & GAS
MINING

Part No.	Dimensional Specifications					
	t	w	l	h	t.o.	c/b
ADRT100308	.140/.146	.277/.283	.406/.412	.107/.113	.143/.149	.037/.043

MISC.
SHAPES

Square Shoulder

Square Shoulder Milling Blank With Chipbreaker And ISO Style Hole

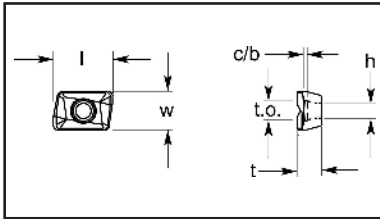

Part No.	Dimensional Specifications					
	t	w	l	h	t.o.	c/b
ADRT100304HM	.174/.180	.277/.283	.406/.412	.107/.113	.143/.149	.037/.043

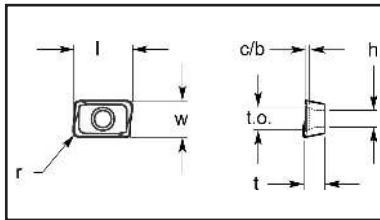

Part No.	Dimensional Specifications						
	t	w	l	h	t.o.	c/b	r
ADST150516RHM	.224/.228	.373/.377	.612/.616	.176/.182	.244/.250	.027/.033	.063

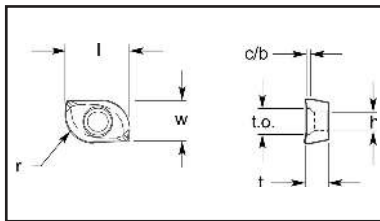

Part No.	Dimensional Specifications						
	t	w	l	h	t.o.	c/b	r
ADRT150564RHM	.212/.216	.390/.394	.593/.597	.177/.183	.245/.251	.027/.033	.250

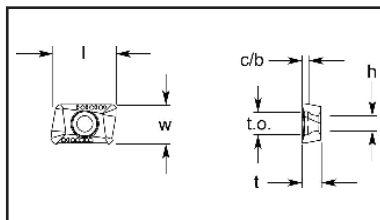

Part No.	Dimensional Specifications					
	t	w	l	h	t.o.	c/b
APRT160412EXM	.193/.199	.408/.414	.644/.650	.157/.163	.233/.239	.022/.028

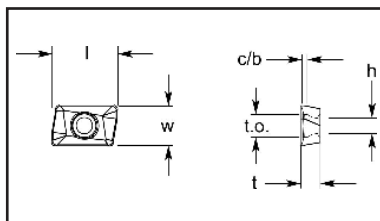

Part No.	Dimensional Specifications					
	t	w	l	h	t.o.	c/b
APRT160412	.193/.199	.408/.414	.644/.650	.157/.163	.233/.239	.052/.058

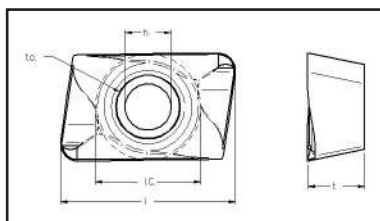

Part No.	Dimensional Specifications					
	t	w	l	h	t.o.	c/b
APST434	.209/.215	.393/.399	.649/.655	.168/.178	.231/.241	0.031

TURNING
MILLING
GROOVING
DRILLING
THREADING
BRAZED
BLANKS
RECTANGLES
STB
WOOD
WORKING
OIL & GAS
MINING
MISC.
SHAPES



Stick Blank Gear Blanks

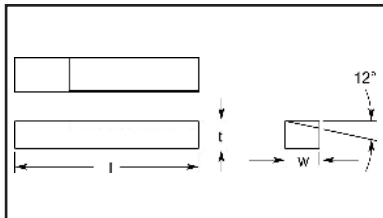

Part No.	Dimensional Specifications		
	t	w	l
4X5X4.0-12LH	.420/.430	.520/.530	4.000/4.030
4X5X4.0-12RH	.420/.430	.520/.530	4.000/4.030
6/775/4.25/12L	.620/.630	.795/.805	4.250/4.280
6/775/4.25/12R	.620/.630	.795/.805	4.250/4.280

Wedge Blank PCD

Wedge Style Milling Blank

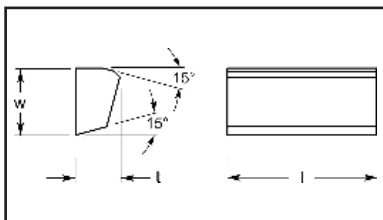

Part No.	Dimensional Specifications		
	t	w	l
UDLB1	.262/.272	.390/.400	.890/.900

Hexagons

Negative Hexagon

- variable thickness quoted on request

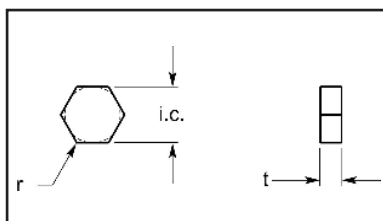

Part No.	Dimensional Specifications		
	t	i.c.	r
HNR532	.195/.200	.638/.642	1/32
HNR530	.198/.206	.639/.645	0
HNR630	.198/.206	.764/.770	0
HNR633	.198/.206	.764/.770	3/64

Positive Hexagon

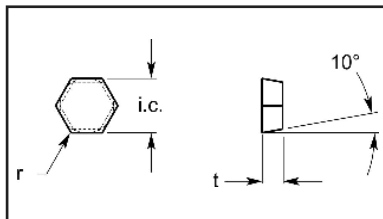

Part No.	Dimensional Specifications		
	t	i.c.	r
HPR531	.198/.206	.639/.645	1/64
HPR631	.198/.206	.764/.770	1/64
WHPR532	.202/.207	.663/.673	1/32
WHPR633	.202/.207	.788/.798	3/64

Octagons

Negative Octagon

- variable thickness quoted on request

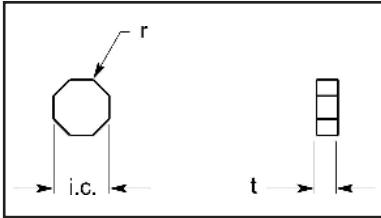

Part No.	Dimensional Specifications		
	t	i.c.	r
ONR320	.137/.143	.390/.396	0
ONR420	.135/.143	.514/.520	0
ONR430	.202/.207	.514/.520	0
ONR630	.198/.206	.760/.766	0
ONR640	.260/.268	.764/.770	0

Positive Octagon With Hole And Countersink

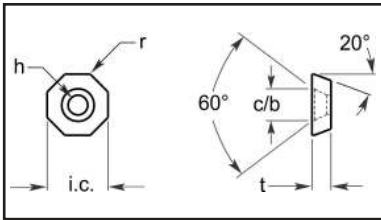

Part No.	Dimensional Specifications				
	t	i.c.	h	c/b	r
OERW532-UM	.198/.206	.639/.645	.211/.217	.307/.313	1/32

Positive Octagon With ISO Style Hole

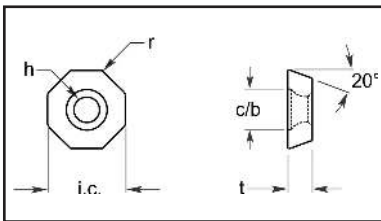

Part No.	Dimensional Specifications				
	t	i.c.	h	c/b	r
OERB532-UM	.205/.213	.639/.645	.201/.207	.327/.333	1/32

Negative Octagon With Hole

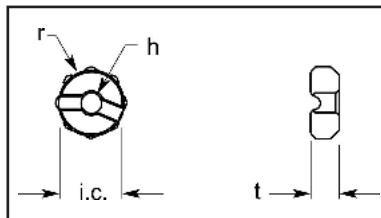

Part No.	Dimensional Specifications			
	t	i.c.	h	r
853OCTX343T	.360/.366	.848/.858	.245/.255	.317/.327
997OCTX445T	.462/.468	.992/1.002	.290/.300	.560/.570

TURNING

MILLING

GROOVING

DRILLING

THREADING

BRAZED
BLANKS

RECTANGLES
STB

WOOD
WORKING

OIL & GAS
MINING

MISC.
SHAPES

TURNING

Ultra-met[®]

carbide technologies

FABRICATOR & TOOLMAKER
Capabilities Catalog

Octagons

MILLING

Positive Octagon

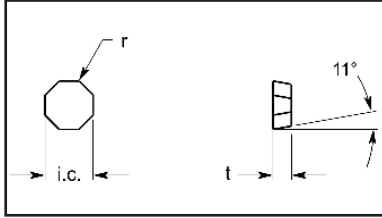

Part No.	Dimensional Specifications		
	t		
OPR430	.198/.206	.514/.520	0
OPR640	.260/.268	.764/.770	0

GROOVING

Negative Octagon With Chipbreakers • variable thickness quoted on request

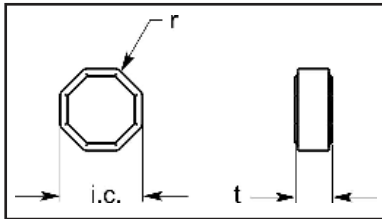

Part No.	Dimensional Specifications		
	t	i.c.	r
ONSF544F	.276/.282	.620/.630	1/16

DRILLING

THREADING

BRAZED
BLANKSRECTANGLES
STBWOOD
WORKINGOIL & GAS
MININGMISC.
SHAPES

Pentagons

TURNING

MILLING

GROOVING

DRILLING

THREADING

BRAZED
BLANKS

RECTANGLES
STB

WOOD
WORKING

OIL & GAS
MINING

MISC.
SHAPES

Negative Pentagon • variable thickness quoted on request

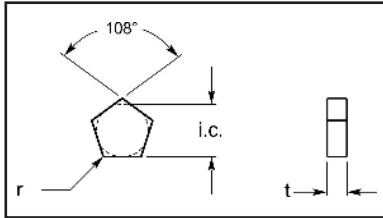

Part No.	Dimensional Specifications		
	t	i.c.	r
PM10-3-0	.104/.112	.325/.332	0
PNR220	.104/.114	.260/.268	0
PNR320	.135/.143	.389/.395	0
PNR420	.135/.143	.514/.520	0
PNR430	.198/.206	.514/.520	0
PNR432	.198/.206	.514/.520	1/32
PNR630	.200/.208	.767/.777	0
PNR634	.202/.208	.767/.777	1/16
* PNS332	.200/.208	.372/.378	1/32
* PNS433	.199/.205	.497/.503	3/64

* No grind stock on periphery

Negative Pentagon With Hole • variable thickness quoted on request

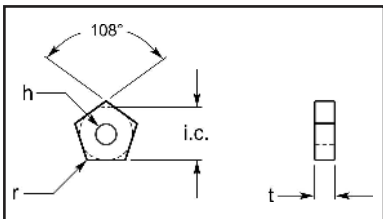

Part No.	Dimensional Specifications			
	t	i.c.	r	h
PNRA640	.265/.275	.767/.777	0	.247/.253
* PNSA332	.200/.208	.372/.378	1/32	.148/.152
* PNSA433	.199/.205	.497/.503	3/64	.200/.206

* No grind stock on periphery

NEW Round Positive Milling Insert

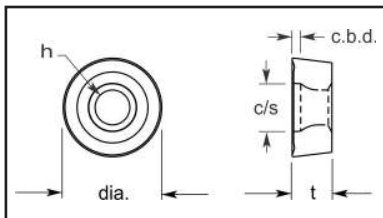

Part No.	Dimensional Specifications				
	t	dia.	h	c/s	c.b.d
RCRT1204MOHP	.194/.200	.486/.492	.170/.176	.233/.239	.032/.038

TURNING

Ultra-met®

carbide technologies

FABRICATOR & TOOLMAKER
Capabilities Catalog

Round

MILLING



Round Positive Milling Insert

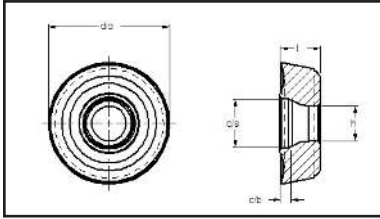

Part No.	Dimensional Specifications				
	t	dia.	h	c/s	c/b
RPLH190500TN-B	.243/.253	.748/.754	.213/.219	.292/.298	.062/.072

GROOVING

Square

DRILLING

Square Negative Serrated Milling

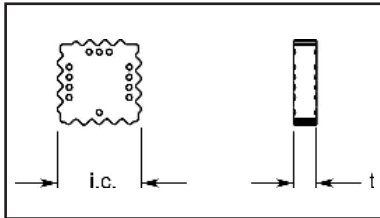

Part No.	Dimensional Specifications	
	i.c.	t
U4T75	.747/.753	.202/.206
U4T75Q	.747/.753	.265/.269

THREADING

Utility Square Negative Chipbreaker With ISO Style Hole

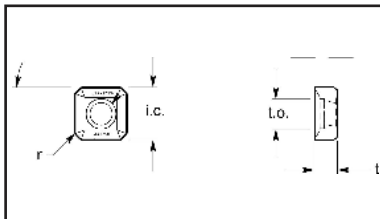

Part No.	Dimensional Specifications					
	i.c.	t	h	t.o.	c/b	r
SNSX1305AN	.509/.515	.224/.230	.214/.220	.292/.298	.016 deep	.016

BRAZED
BLANKSRECTANGLES
STB

Square Negative Double Facets

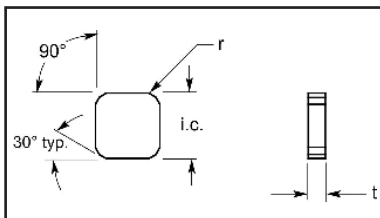

Part No.	Dimensional Specifications		
	i.c.	t	r
SNR63K	.764/.770	.198/.206	0

WOOD
WORKINGOIL & GAS
MININGMISC.
SHAPES

Square

Utility Serrated Square Negative • variable thickness quoted on request

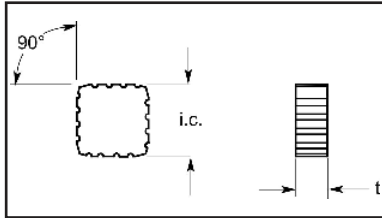

Part No.	Dimensional Specifications	
	i.c.	t
DWG#U-3326.187T	.752/.758	.202/.207
DWG#U-3326.250T	.752/.758	.265/.270

Serrated Square With Hole And Dbl Countersink

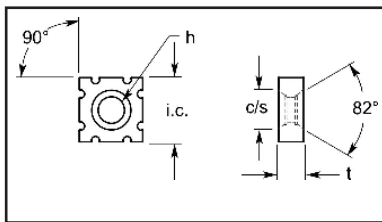

Part No.	Dimensional Specifications			
	i.c.	t	h	c/s
SCBIR430-MOD	.514/.520	.198/.206	.206/.212	.320/.326

Square Positive Chipbreaker With ISO Style Hole

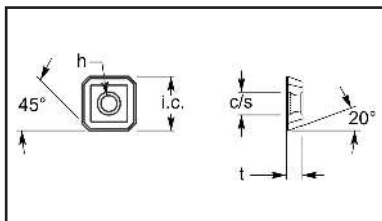

Part No.	Dimensional Specifications			
	i.c.	t	h	c/s
SERX.528IC.156T	.542/.548	.161/.167	.178/.164	.229/.235
SERX1304AFN	.527/.533	.193/.199	.214/.220	.292/.298

Square Positive Chipbreaker With Hole And Countersink

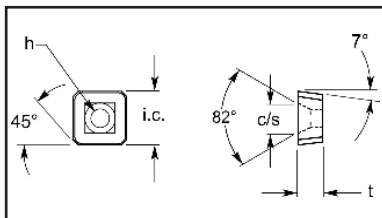

Part No.	Dimensional Specifications			
	i.c.	t	h	c/s
DWG#U-3766	.514/.520	.200/.206	.198/.202	.289/.295

Square Positive Chipbreaker With Hole And Countersink

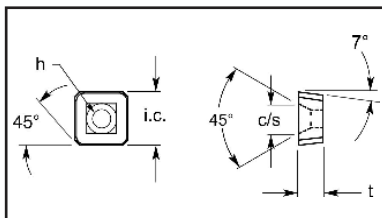

Part No.	Dimensional Specifications			
	i.c.	t	h	c/s
DWG#U4171	.514/.520	.200/.206	.212/.218	.275/.281

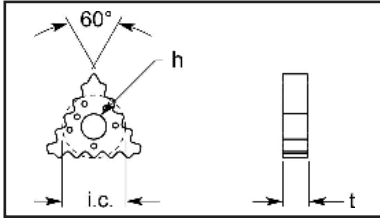
Triangle Negative Serrated Milling With Hole • variable thickness quoted on request

Part No.	Dimensional Specifications		
	i.c.	t	h
U3T50	.497/.503	.202/.206	.200/.206
U3T50Q	.497/.503	.264/.268	.200/.206

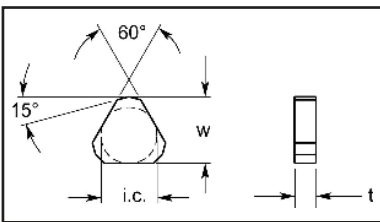
Triangle Negative Double Facet

Part No.	Dimensional Specifications		
	i.c.	t	w
TNRN1204AN	.520/.527	.198/.206	.609/.623

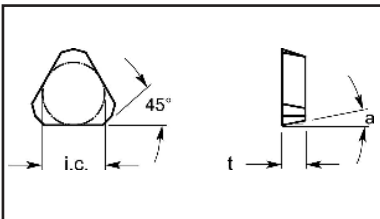
Triangle Positive Double Facet

Part No.	Dimensional Specifications			
	i.c.	t	clear	flat
TPK43PDR/PDL	.497/.503	.198/.202	11° 30'	.008 max

1000 Series

TURNING

MILLING

GROOVING

DRILLING

THREADING

BRAZED
BLANKS

RECTANGLES
STB

WOOD
WORKING

OIL & GAS
MINING

MISC.
SHAPES

TURNING

MILLING

GROOVING

DRILLING

THREADING

**BRAZED
BLANKS**

**RECTANGLES
STB**

**WOOD
WORKING**

**OIL & GAS
MINING**

**MISC.
SHAPES**

1000 Series

TURNING

MILLING

GROOVING

DRILLING

THREADING

**BRAZED
BLANKS**

**RECTANGLES
STB**

**WOOD
WORKING**

**OIL & GAS
MINING**

**MISC.
SHAPES**

TURNING

MILLING

GROOVING

DRILLING

THREADING

BRAZED
BLANKS

RECTANGLES
STB

WOOD
WORKING

OIL & GAS
MINING

MISC.
SHAPES

1000 Series

TURNING

MILLING

GROOVING

DRILLING

THREADING

**BRAZED
BLANKS**

**RECTANGLES
STB**

**WOOD
WORKING**

**OIL & GAS
MINING**

**MISC.
SHAPES**

TURNING

MILLING

GROOVING

DRILLING

THREADING

BRAZED
BLANKS

RECTANGLES
STB

WOOD
WORKING

OIL & GAS
MINING

MISC.
SHAPES

1000 Series

TURNING

MILLING

GROOVING

DRILLING

THREADING

**BRAZED
BLANKS**

**RECTANGLES
STB**

**WOOD
WORKING**

**OIL & GAS
MINING**

**MISC.
SHAPES**

TURNING

MILLING

GROOVING

DRILLING

THREADING

**BRAZED
BLANKS**

**RECTANGLES
STB**

**WOOD
WORKING**

**OIL & GAS
MINING**

**MISC.
SHAPES**