

Diamond Positive

TURNING

78° Diamond Positive

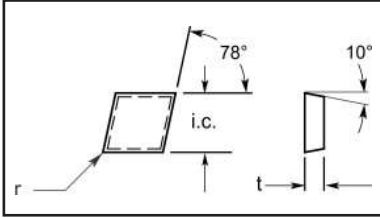

Part No.	Dimensional Specifications		
	i.c.	t	r
1160AS	.645/.651	.208/.214	0

MILLING

80° Diamond Positive

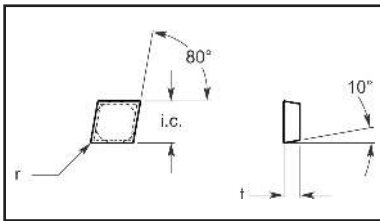

Part No.	Dimensional Specifications		
	i.c.	t	r
CPR320	.389/.395	.135/.143	0
CPR322	.389/.395	.135/.143	1/32
CPR420	.514/.520	.135/.143	0
CPR630	.764/.770	.198/.206	0

GROOVING

DRILLING

80° Diamond Positive With ISO Style Hole

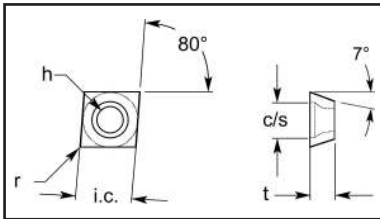

Part No.	Dimensional Specifications				
	i.c.	t	h	c/s	r
CCRW32.50	.389/.395	.166/.174	.171/.175	.233/.239	0

THREADING

BRAZED
BLANKS

80° Diamond Positive With ISO Style Hole

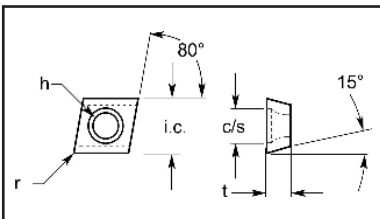

Part No.	Dimensional Specifications				
	i.c.	t	h	c/s	r
CDRW32.50LH	.389/.395	.171/.176	.160/.164	.216/.222	0

RECTANGLES
STB

WOOD
WORKING

OIL & GAS
MINING

MISC.
SHAPES

TURNING
MILLING
GROOVING
DRILLING
THREADING
BRAZED BLANKS
RECTANGLES STB
WOOD WORKING
OIL & GAS MINING
MISC. SHAPES

80° Diamond Negative With ISO Style Hole

• to be ground positive

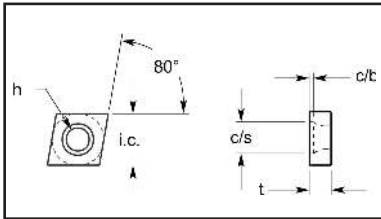

Part No.	Dimensional Specifications				
	i.c.	t	h	c/s	c/b
CNRW1.51.50	.199/.209	.106/.114	.082/.088	.111/.117	.017/.023
CNRW1.81.50	.233/.239	.104/.110	.095/.101	.127/.133	.036/.042
CNRW21.50	.264/.270	.104/.112	.107/.113	.143/.149	.036/.042
CNRW220	.264/.270	.136/.142	.107/.113	.143/.149	.036/.042
CNRW32.50	.389/.395	.167/.173	.170/.176	.233/.239	.034/.040
CNRW32.50R/L	.389/.395	.166/.174	.158/.164	.216/.222	.043
CNRW330	.389/.395	.199/.205	.170/.176	.233/.239	.037
CNRW430	.514/.520	.198/.206	.213/.219	.292/.298	.043/.049
CNRW53.50	.639/.645	.229/.237	.221/.227	.317/.323	.039/.045
CNRW530	.639/.645	.198/.206	.221/.227	.317/.323	.039/.045

80° Diamond Negative F5 Chipbreaker With ISO Style Hole

• to be ground positive

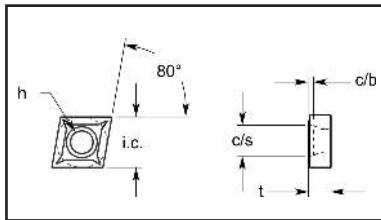

Part No.	Dimensional Specifications					
	i.c.	t	h	c/s	c/b	r
CNRT1.81.50-F5	.264/.270	.109/.115	.107/.113	.143/.149	.029/.035	0
CNRT1.81.51-F5	.264/.270	.109/.115	.107/.113	.143/.149	.029/.035	0
CNRT21.51F5	.264/.270	.109/.115	.107/.113	.143/.149	.029/.035	0
CNRT21.52F5	.264/.270	.109/.115	.107/.113	.143/.149	.029/.035	0
CNRT22.52F5	.264/.270	.170/.176	.107/.113	.143/.149	.029/.035	0
CNRT221F5	.264/.270	.140/.146	.107/.113	.143/.149	.029/.035	0
CNRT32.51F5	.389/.395	.172/.178	.170/.176	.233/.239	.027/.033	0
CNRT32.52F5	.389/.395	.172/.178	.170/.176	.233/.239	.027/.033	0
CNRT431F5	.514/.520	.204/.210	.213/.219	.292/.298	.037/.043	0
CNRT432F5	.514/.520	.204/.210	.213/.219	.292/.298	.037/.043	0

80° Diamond Positive With Dimple

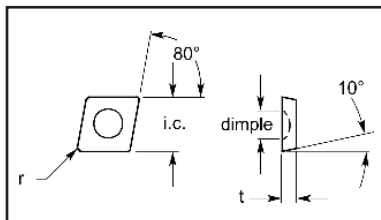

Part No.	Dimensional Specifications			
	i.c.	t	dimple dia.	r
DWG#U-4154	.389/.395	.135/.143	.187	1/32

80° Diamond Positive Chipbreaker With Hole

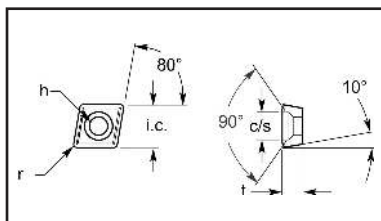

Part No.	Dimensional Specifications				
	i.c.	t	h	c/s	r
DWG#C-6066	.389/.395	.186/.191	.157/.163	.247/.253	1/32

Diamond Positive

TURNING

85° Diamond Positive

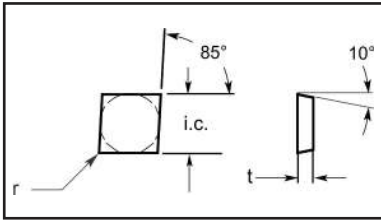

Part No.	Dimensional Specifications		
	i.c.	t	r
APR533	.643/.648	.198/.206	3/64

MILLING

85° 86° Diamond Positive With Hole

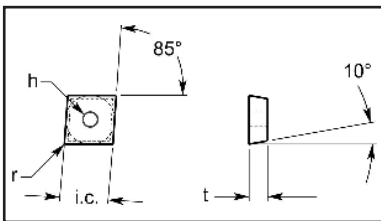

Part No.	Dimensional Specifications			
	t	i.c.	h	r
APRA533.125HOLE	.198/.206	.643/.648	.125/.135	3/64

GROOVING

DRILLING

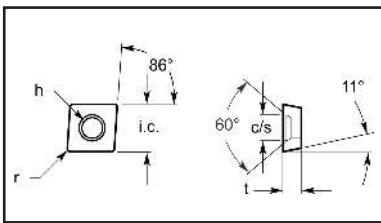

Part No.	Dimensional Specifications				
	i.c.	t	h	c/s	r
E-21560	.511/.519	.194/.200	.219/.223	.276/.282	1/32

THREADING

BRAZED
BLANKS

86° Diamond Positive With ISO Style Hole

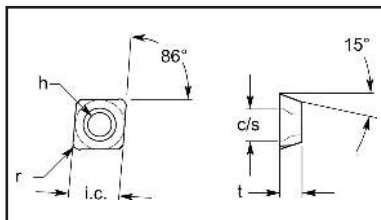

Part No.	Dimensional Specifications				
	i.c.	t	h	c/s	r
MDRW5-16.197T	.639/.645	.208/.214	.217/.221	.297/.301	1/4
MDRW438	.514/.520	.198/.206	.216/.222	.296/.301	1/8

RECTANGLES
STB

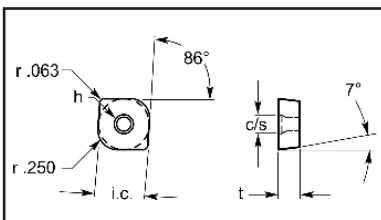

Part No.	Dimensional Specifications			
	i.c.	t	h	c/s
MCRW5416	.639/.645	.260/.268	.173/.177	.234/.238

WOOD
WORKING

OIL & GAS
MINING

MISC.
SHAPES

86° 87° Diamond Positive

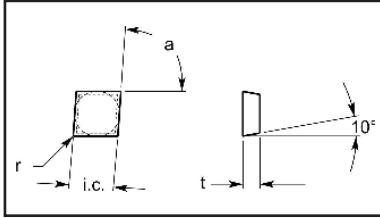

MPR, NPR, PRPR and UP Styles may overlap in Dimensional Specifications
Different nomenclature is only for individual customers reference.

Part No.	Dimensional Specifications			
	i.c.	t	r	a
MPR532/87	.639/.645	.198/.206	1/32	87°
MPR551/87	.639/.645	.166/.174	1/64	87°
MPR630	.764/.770	.198/.206	0	86°

Part No.	Dimensional Specifications			
	i.c.	t	r	a
NPR430	.514/.520	.198/.206	0	87°
NPR532	.639/.645	.198/.206	1/32	87°
NPR630	.764/.770	.198/.206	0	87°

Part No.	Dimensional Specifications			
	i.c.	t	r	a
PRPR430	.514/.520	.198/.206	0	87°
PRPR630	.764/.770	.198/.206	0	87°

Part No.	Dimensional Specifications			
	i.c.	t	r	a
UP33	.369/.375	.164/.170	1/64	87°
UP43	.474/.480	.198/.206	1/64	87°
UP53	.699/.705	.198/.206	1/64	87°
UP63	.764/.770	.198/.206	0	87°
UP66N	.764/.770	.198/.206	0	87°



55° Diamond Positive Aluminum Top Form

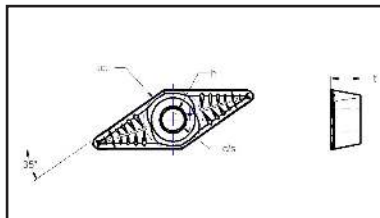

Part No.	Dimensional Specifications				
	i.c.	t	h	c/s	r
VPRT220612	.518/.524	.278/.284	.200/.206	.237/.243	.058

55° Diamond Positive

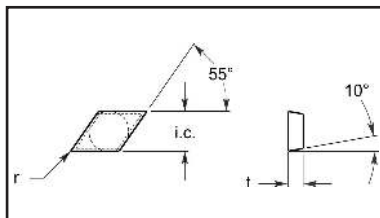

Part No.	Dimensional Specifications		
	i.c.	t	r
DPR430	.514/.520	.198/.206	0

55° Diamond Positive With Hole

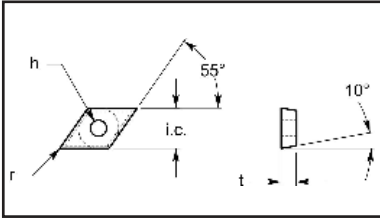

Part No.	Dimensional Specifications			
	i.c.	t	h	r
DPRA320	.389/.395	.135/.143	.148/.152	0
DPRA430	.514/.520	.198/.206	.201/.205	0
DPRA530	.639/.645	.198/.206	.248/.252	0

55° Diamond Positive With ISO Style Hole

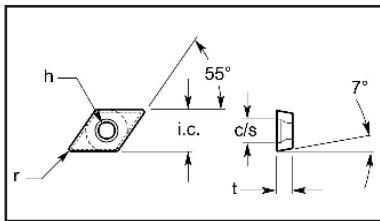

Part No.	Dimensional Specifications				
	i.c.	t	h	c/s	r
DCSW32.50	.373/.377	.167/.173	.168/.174	.233/.239	.008

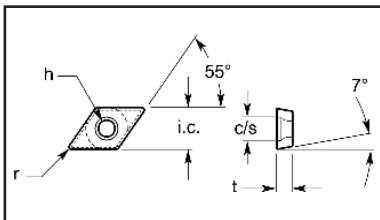

Part No.	Dimensional Specifications				
	i.c.	t	h	c/s	r
DCRW32.50	.380/.390	.166/.174	.168/.174	.233/.239	.008

55° Diamond Negative With ISO Style Hole

• to be ground positive

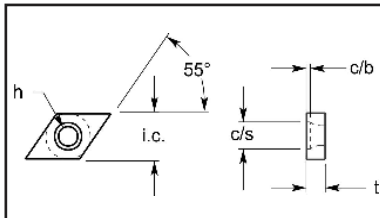

Part No.	Dimensional Specifications				
	i.c.	t	h	c/s	c/b
DNRW21.50	.264/.270	.104/.112	.107/.113	.143/.149	.036/.042
DNRW220	.264/.270	.135/.143	.107/.113	.143/.149	.036/.042
DNRW32.50	.389/.395	.166/.174	.170/.176	.233/.239	.046/.052
DNRW330	.389/.395	.198/.206	.170/.176	.233/.239	.046/.052
DNRW430	.514/.520	.198/.206	.213/.219	.292/.298	.043/.049

55° Diamond Negative F5 Chipbreaker With ISO Style Hole

• to be ground positive

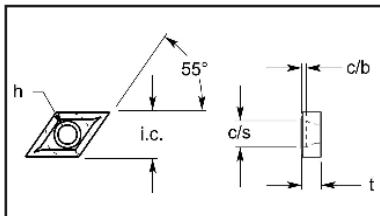

Part No.	Dimensional Specifications				
	i.c.	t	h	c/s	c/b
DNRT21.51F5	.264/.270	.109/.115	.107/.113	.143/.149	.029/.035
DNRT21.52F5	.264/.270	.109/.115	.107/.113	.143/.149	.029/.035
DNRT32.51F5	.389/.395	.172/.178	.170/.176	.233/.239	.040/.046
DNRT32.52F5	.389/.395	.172/.178	.170/.176	.233/.239	.040/.046
DNRT431F5	.514/.520	.205/.211	.213/.219	.292/.298	.037/.043
DNRT432F5	.514/.520	.205/.211	.213/.219	.292/.298	.037/.043

TURNING
MILLING
GROOVING
DRILLING
THREADING
BRAZED BLANKS
RECTANGLES STB
WOOD WORKING
OIL & GAS MINING
MISC. SHAPES

55° Diamond Positive With Flats

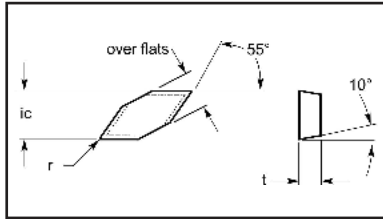

Part No.	Dimensional Specifications			
	i.c.	t	over flats	r
DPR531F	.639/.645	.198/.206	.464/.470	1/64

55° U-Notch Style

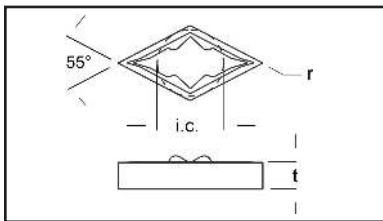

Part No.	Dimensional Specifications		
	t	i.c.	r
DNRR430	.200/.206	.514/.520	0

35° U-Notch Style

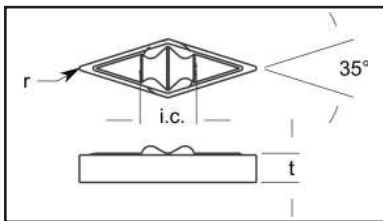

Part No.	Dimensional Specifications		
	t	i.c.	r
VNRR331	.200/.206	.389/.395	1/64
VNRR332	.200/.206	.389/.395	1/64
VNRR333	.200/.206	.389/.395	1/64

35° Diamond Positive With Hole

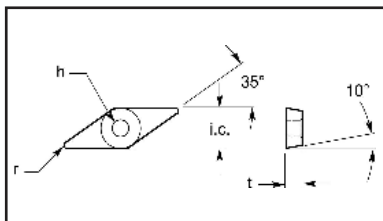

Part No.	Dimensional Specifications			
	i.c.	t	h	r
VPRA441	.517/.523	.265/.271	.201/.205	1/64

35° Diamond Negative With ISO Style Hole

• to be ground positive

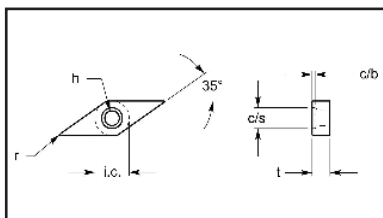

Part No.	Dimensional Specifications					
	i.c.	t	h	c/s	c/b	r
VNRW21.51	.264/.270	.104/.112	.107/.113	.155/.160	.019/.027	1/64
VNRW221	.264/.270	.135/.143	.107/.113	.155/.160	.019/.027	1/64
VNRW32.50	.389/.395	.166/.174	.170/.176	.233/.239	.046/.052	0
VNRW330	.389/.395	.198/.206	.170/.176	.233/.239	.046/.052	0

35° Diamond Negative F5 Chipbreaker With ISO Style Hole

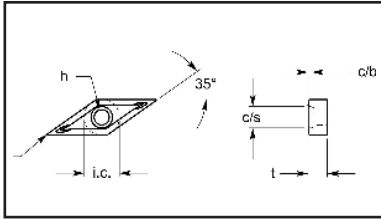

- to be ground positive

Part No.	Dimensional Specifications					
	i.c.	t	h	c/s	c/b	r
VNRT21.51F5	.264/.270	.109/.115	.108/.112	.143/.149	.028/.036	1/64
VNRT21.52F5	.264/.270	.109/.115	.108/.112	.143/.149	.028/.036	1/64
VNRT221F5	.264/.270	.141/.147	.108/.112	.143/.149	.028/.036	1/64
VNRT222F5	.264/.270	.141/.147	.108/.112	.143/.149	.028/.036	1/64
VNRT32.51F5	.389/.395	.173/.179	.170/.176	.233/.239	.038/.044	0
VNRT32.52F5	.389/.395	.173/.179	.170/.176	.233/.239	.038/.044	0
VNRT32.53F5	.389/.395	.173/.179	.170/.176	.233/.239	.038/.044	0
VNRT331F5	.389/.395	.204/.211	.170/.176	.233/.239	.038/.044	0
VNRT332F5	.389/.395	.204/.211	.170/.176	.233/.239	.038/.044	0
VNRT333F5	.389/.395	.204/.211	.170/.176	.233/.239	.038/.044	0

Round Negative • variable thickness quoted on request

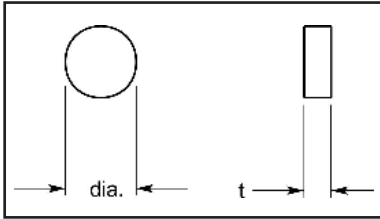

Part No.	Dimensional Specifications	
	t	dia.
RNRN45	.322/.330	.514/.520
RNR1.21.5	.104/.112	.171/.181
RNR1.51	.072/.077	.197/.207
RNR1.51.5	.104/.112	.199/.205
RNR2.51.5	.104/.112	.326/.332
RNR2.54	.260/.268	.326/.332
RNR21	.073/.081	.262/.268
RNR21.5	.104/.112	.262/.268
RNR22	.135/.143	.262/.268
RNR23	.198/.206	.262/.268
RNR31	.072/.080	.389/.395
RNR32	.135/.143	.389/.395
RNR32.5	.166/.174	.389/.395
RNR33	.198/.206	.389/.395
RNR34	.260/.268	.389/.395
RNR35	.323/.331	.389/.395
RNR36	.385/.393	.389/.395
RNR42	.135/.143	.514/.520
RNR43	.198/.206	.514/.520
RNR44	.260/.268	.514/.520
RNR45	.322/.330	.514/.520
RNR5.51	.070/.080	.687/.712
RNR51	.072/.080	.639/.645
RNR52	.135/.143	.639/.645
RNR53	.198/.206	.639/.645
RNR54	.260/.268	.639/.645
RNR55	.322/.330	.639/.645
RNR56	.385/.393	.639/.645
RNR62	.135/.143	.764/.770
RNR63	.198/.206	.764/.770
RNR64	.260/.268	.764/.770
RNR66	.385/.393	.764/.770
RNR78	.516/.524	.890/.900
RNR82	.142/.147	1.020/1.030
RNR83	.205/.210	1.020/1.030
RNR84	.267/.272	1.020/1.030
RNR86	.393/.398	1.020/1.030
RNR106	.390/.400	1.272/1.292
RNR108	.530/.540	1.272/1.292
RNR124	.259/.269	1.515/1.535
RNR126	.390/.400	1.515/1.535
RNR168	.516/.524	2.045/2.065

Round Negative

TURNING

Round Negative With Hole • variable thickness quoted on request

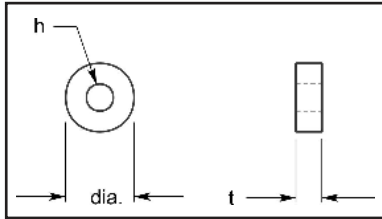

Part No.	Dimensional Specifications		
	t	dia.	h
RNRA1.25	.323/.331	.170/.176	.064/.070
RNRA2.5	.323/.331	.322/.328	.111/.117
RNRA3.128H	.040/.055	.385/.400	.120/.110
RNRA3.25	.323/.331	.400/.406	.128/.134
RNRA32	.135/.143	.389/.395	.147/.153
RNRA33	.198/.206	.389/.395	.147/.153
RNRA34	.260/.268	.389/.395	.147/.153
RNRA41.125HOLE	.072/.080	.514/.520	.123/.127
RNRA42	.135/.143	.514/.520	.201/.205
RNRA43	.198/.206	.514/.520	.200/.206
RNRA44	.260/.268	.514/.520	.200/.206
RNRA46	.385/.393	.514/.520	.200/.206
RNRA5.5.233H	.070/.080	.687/.712	.232/.240
RNRA52	.135/.143	.639/.645	.247/.253
RNRA54	.260/.268	.639/.645	.247/.253
RNRA63	.198/.206	.764/.770	.309/.315
RNRA64	.260/.268	.764/.770	.309/.315
RNRA64.251HOLE	.260/.268	.764/.770	.251/.256
RNRA65	.323/.331	.764/.770	.309/.315
RNRA65.251H	.322/.330	.763/.773	.248/.254
RNRA66	.385/.393	.764/.770	.309/.315
RNRA78	.515/.525	.830/.840	.309/.315

MILLING

GROOVING

DRILLING

THREADING

BRAZED
BLANKS

Round Negative With Hole And Countersink

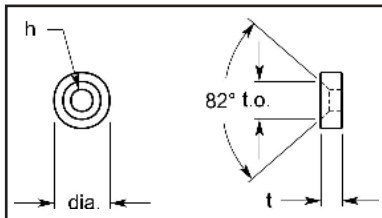

Part No.	Dimensional Specifications			
	t	dia.	h	t.o.
RNRB32.5-#4	.166/.174	.389/.395	.123/.127	.267/.273
RNRB33-#4	.198/.206	.389/.395	.123/.127	.267/.273
RNRB43-#8	.198/.206	.514/.520	.177/.183	.373/.379

RECTANGLES
STB

Round Negative With Hole

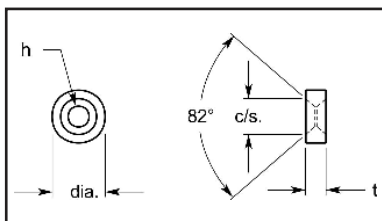

Part No.	Dimensional Specifications			
	t	dia.	h	c/s
RNRC43	.198/.206	.514/.520	.200/.206	.326/.332
RNRC43-40	.198/.206	.514/.520	.174/.180	.233/.239
RNRC43.209HOLE	.198/.206	.514/.520	.206/.212	.326/.332

WOOD
WORKING

OIL & GAS
MINING

MISC.
SHAPES

TURNING
MILLING
GROOVING
DRILLING
THREADING
BRAZED BLANKS
RECTANGLES STB
WOOD WORKING
OIL & GAS MINING
MISC. SHAPES

Round Negative

Round Negative With Chipbreaker

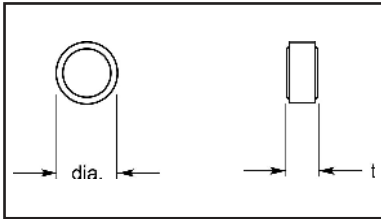

Part No.	Dimensional Specifications			
	t	dia.	h	c/s
RNRF55	.322/.330	.639/.645	0	0

Round Negative With Hole

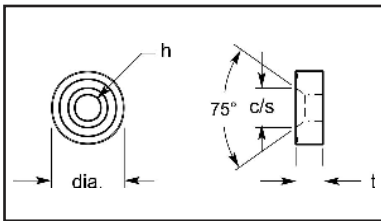

Part No.	Dimensional Specifications			
	t	dia.	h	c/s
RNRH43	.193/.199	.514/.520	.213/.219	.313/.319
RNRH85	.320/.326	1.026/1.034	.356/.362	.539/.545
RNRH86	.382/.388	1.026/1.034	.356/.362	.539/.545

Round Negative With Dbl Countersink Hole

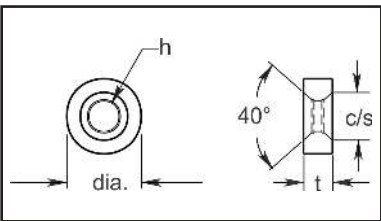

Part No.	Dimensional Specifications			
	t	dia.	h	c/s
RNRQ44-40°.177H	.260/.268	.514/.520	.175/.179	.233/.239

Round Negative F5 Chipbreaker With ISO Style Hole

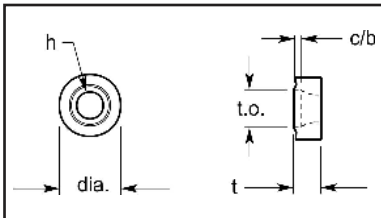

Part No.	Dimensional Specifications				
	t	dia.	h	c/s	c/b
RNRT21.51F5	.109/.115	.262/.268	.107/.113	.143/.149	.029/.035
RNRT21.5F5	.109/.115	.262/.268	.107/.113	.143/.149	.029/.035
RNRT22F5	.141/.147	.262/.268	.107/.113	.143/.149	.029/.035
RNRT32.5F5	.169/.175	.389/.395	.170/.176	.233/.239	.040/.046
RNRT32F5	.138/.144	.389/.395	.170/.176	.233/.239	.040/.046
RNRT43F5	.204/.210	.514/.520	.213/.219	.292/.298	.037/.043
RNRT53F5	.205/.211	.639/.645	.213/.219	.292/.298	.040
RNRT54F5	.267/.273	.639/.645	.213/.219	.292/.298	.040
RNRT10T3MO	.169/.175	.407/.413	.170/.176	.233/.239	.040/.046

Round Negative

TURNING

Round Negative With Chipbreaker Hole and Countersink

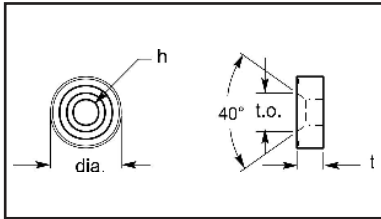

Part No.	Dimensional Specifications			
	t	dia.	h	t.o.
RNRT2507MO	.318/.328	.995/1.005	.339/.345	.475/.481

MILLING

Round Negative With Chipbreaker And Hole

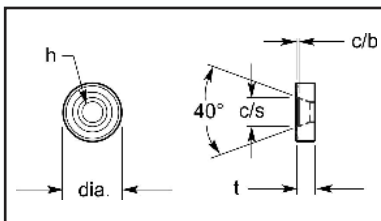

Part No.	Dimensional Specifications				
	t	dia.	h	c/s	c/b
RNRT2507MO-UM	.318/.328	.995/1.005	.299/.305	.432/.438	.037/.043

GROOVING

DRILLING

Round Negative With ISO Style Hole

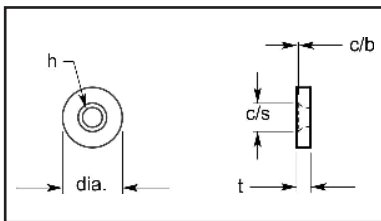

Part No.	Dimensional Specifications				
	t	dia.	h	c/s	c/b
RNRW21.5	.105/.111	.262/.268	.107/.113	.143/.149	.036/.042
RNRW22	.135/.143	.262/.268	.107/.113	.143/.149	.036/.042
RNRW32.5	.166/.174	.389/.395	.170/.176	.233/.239	.046/.052
RNRW42.5	.166/.174	.514/.520	.213/.219	.292/.298	.042/.050
RNRW43	.198/.206	.514/.520	.213/.219	.292/.298	.042/.050
RNRW53	.198/.206	.644/.650	.213/.219	.292/.298	.042/.050
RNRW53.5	.228/.236	.644/.650	.213/.219	.292/.298	.042/.050
RNRW160400	.198/.206	.644/.650	.205/.211	.301/.307	.023/.031
RNRW1604MO	.198/.206	.644/.650	.213/.219	.292/.298	.042/.050
RNRW1605MO	.228/.236	.644/.650	.213/.219	.292/.298	.042/.050

THREADING

BRAZED
BLANKS

Utility Round Negative • variable thickness quoted on request

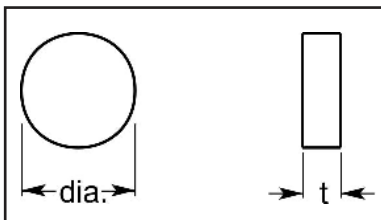

Part No.	Dimensional Specifications	
	t	dia.
RNS32	.135/.143	.372/.378
RNS33	.198/.206	.372/.378
RNS43	.198/.206	.497/.503
RNS84	.265/.270	.996/1.004
1.000DIAX187THK	.182/.192	.996/1.004
RNS104	.265/.275	1.240/1.260

WOOD
WORKING

OIL & GAS
MINING

MISC.
SHAPES

Utility Round Negative With Hole • variable thickness quoted on request

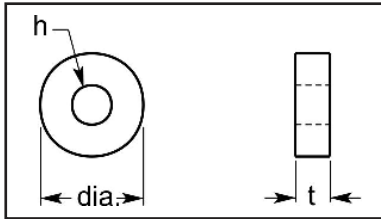

Part No.	Dimensional Specifications		
	t	dia.	h
RNSA32	.135/.143	.373/.377	.147/.153
RNSA33	.198/.206	.373/.377	.147/.153
RNSA34	.260/.268	.373/.377	.147/.153
RNSA43	.198/.206	.497/.503	.200/.206
RNSA44	.260/.268	.497/.503	.200/.206
RNSA54	.260/.268	.622/.628	.247/.253
RNSA56	.385/.393	.622/.628	.247/.253
RNSA.749DIAX250THK	.260/.268	.743/.749	.310/.314
RNSA63	.198/.206	.747/.753	.309/.315
RNSA64	.260/.268	.747/.753	.309/.315
RNSA65	.322/.330	.747/.753	.309/.315
RNSA83	.203/.208	.996/1.004	.361/.365
RNSA84	.265/.270	.996/1.004	.360/.366
RNSA86	.392/.397	.996/1.004	.360/.366
RNSA104	.260/.268	1.234/1.244	.497/.503

Round Negative With Hole Dbl Chamfer

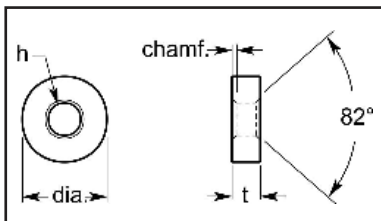

Part No.	Dimensional Specifications			
	t	dia.	h	chamf.
RNSA106	.385/.395	1.246/1.254	.497/.503	.030 X 45°

Round Negative With Hole And Countersink

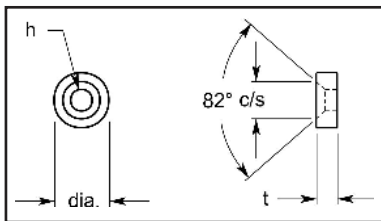

Part No.	Dimensional Specifications		
	t	dia.	h
RNSB108	.515/.525	1.240/1.250	.262/.268

Utility Round Negative With (1) Chipbreaker • variable thickness quoted on request

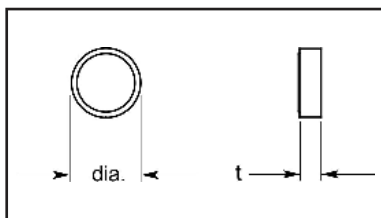

Part No.	Dimensional Specifications	
	t	dia.
RNSF106-1C/B	.417/.423	1.245/1.255

Utility Round Negative With Chipbreakers

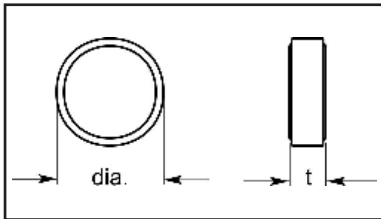

Part No.	Dimensional Specifications	
	t	dia.
RNSF106	.417/.423	1.245/1.255

Utility Round Negative F1 Chipbreakers and Hole

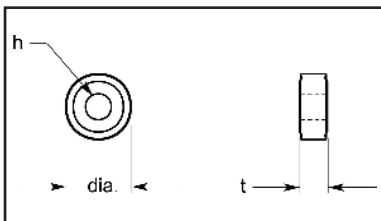

Part No.	Dimensional Specifications		
	t	dia.	h
RNSG32F1	.129/.135	.373/.377	.147/.153
RNSG33F1	.191/.197	.373/.377	.147/.153
RNSG42F1	.129/.135	.497/.503	.200/.206
RNSG43F1	.191/.197	.497/.503	.200/.206

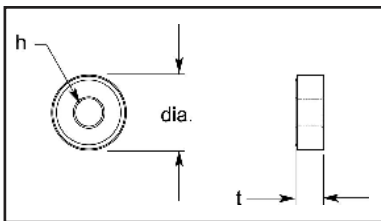

Part No.	Dimensional Specifications		
	t	dia.	h
RNSG43F1-1C/B	.191/.197	.497/.503	.201/.205

Utility Round Negative R1 Chipbreakers and Hole

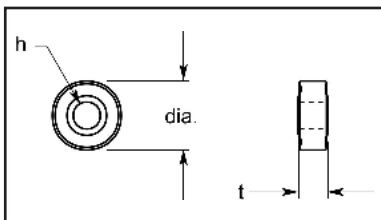

Part No.	Dimensional Specifications		
	t	dia.	h
RNSG43R1	.191/.197	.497/.503	.200/.206
RNSG54R1	.256/.262	.622/.628	.247/.253
RNSG55R1	.318/.324	.622/.628	.247/.253
RNSG64R1	.256/.262	.747/.753	.309/.315
RNSG65R1	.318/.324	.747/.753	.309/.315
RNSG84R1	.256/.262	.996/1.004	.360/.366
RNSG85R1	.318/.324	.996/1.004	.360/.366
RNSG86R1	.381/.387	.996/1.004	.360/.366
RNSG106R1	.370/.380	1.246/1.254	.497/.503

Round Negative With Hole And Countersink

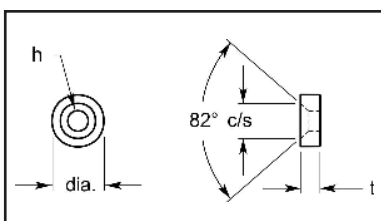

Part No.	Dimensional Specifications			
	dia.	t	h	c/s
URD6.156THK	.389/.395	.166/.174	.123/.127	.267/.273
URD6P-NEG	.389/.395	.135/.143	.122/.128	.267/.273
URD8P-NEG	.514/.520	.135/.143	.122/.128	.267/.273
URD10P-NEG	.639/.645	.135/.143	.175/.181	.373/.379
URD16P-NEG	1.020/1.030	.266/.272	.275/.281	.556/.562

Round Negative • variable thickness quoted on request

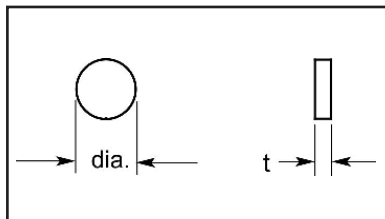

Part No.	Dimensional Specifications	
	t	dia.
.063 DIAX.187T	.191/.215	.074/.080
UDS42	.072/.080	.166/.172
DSP-83-041	.031/.051	.250/.280
250DIAX050THK	.070/.076	.265/.271
250DIAX125LG	.135/.143	.265/.271
DWG#B1310362	.285/.290	.389/.395
DSP204	.135/.143	.639/.645
UDSP-326	.205/.210	1.020/1.030

Round Negative With Hole And Countersink

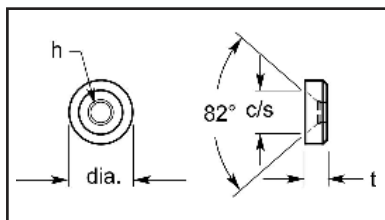

Part No.	Dimensional Specifications			
	t	dia.	h	c/s
USM45	.135/.143	.497/.503	.123/.129	.267/.273

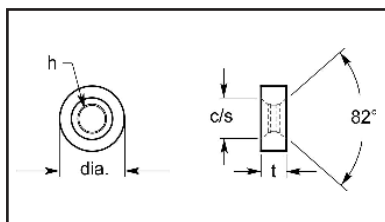

Part No.	Dimensional Specifications			
	t	dia.	h	c/s
RBIR43	.198/.206	.514/.520	.206/.212	.326/.332

Round Negative With Hole and Dbl Countersinks

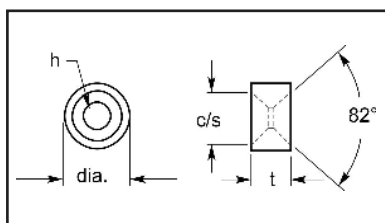

Part No.	Dimensional Specifications			
	t	dia.	h	c/s
9ZE1674D	.198/.206	.514/.520	.200/.206	.324/.334
9ZE1674D-1	.198/.206	.514/.520	.201/.205	.326/.332

Round Negative With Cutout

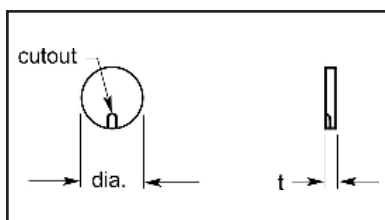

Part No.	Dimensional Specifications		
	t	dia.	cutout
RNR2.045THK-SIZE#3	.040/.050	.262/.268	.040 X .060

Round Negative

TURNING

Round Negative With Hole And Countersink

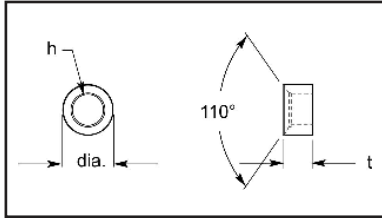

Part No.	Dimensional Specifications		
	t	dia.	h
DWG#W195	.222/.228	.389/.395	.237/.243

MILLING

GROOVING

Utility Round Negative With Hole • variable thickness quoted on request

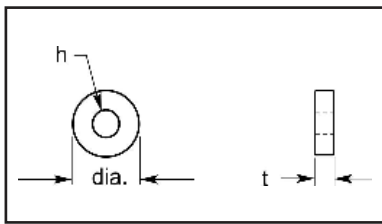

Part No.	Dimensional Specifications		
	t	dia.	h
SK-7223	.130/.140	.465/.475	.251/.255

DRILLING

THREADING

Round Negative With Hole • variable thickness quoted on request

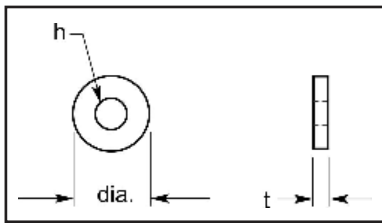

Part No.	Dimensional Specifications		
	t	dia.	h
GC.171DIA.W/.0515H	.050/.053	.168/.174	.049/.054
GC.233D-.080THK	.0775/.0825	.230/.236	.049/.054
GC.233D-W.0515H	.050/.053	.230/.236	.049/.054

BRAZED
BLANKS

Round Negative With Dimple

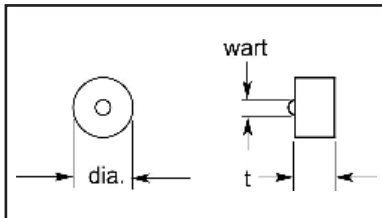

Part No.	Dimensional Specifications		
	t	dia.	wart
DWG#42892	.247/.253	.372/.378	3/32 DIA

RECTANGLES
STB

WOOD
WORKING

OIL & GAS
MINING

MISC.
SHAPES

Round Positive

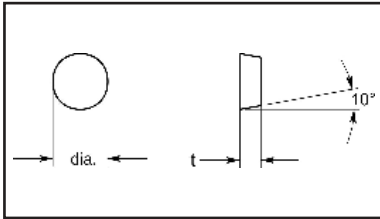

Part No.	Dimensional Specifications	
	t	dia.
RPR32	.135/.143	.389/.395
RPR33	.198/.206	.389/.395
RPR42	.135/.143	.514/.520
RPR43	.198/.206	.514/.520
RPR63	.198/.206	.764/.770
RPR83	.205/.210	1.020/1.030
RPR84	.265/.270	1.020/1.030
RPS43	.202/.207	.496/.504

Utility Round Positive

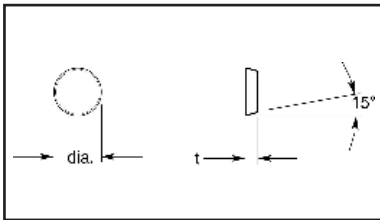

Part No.	Dimensional Specifications	
	t	dia.
RDS84T025-11	.260/.268	.997/1.003

Round Positive With Hole

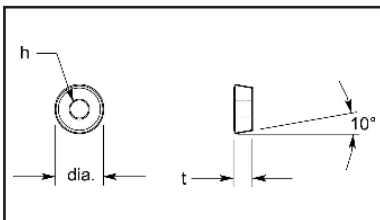

Part No.	Dimensional Specifications		
	t	dia.	h
RPRG32	.129/.135	.379/.385	.148/.152

Round Positive With Dimple

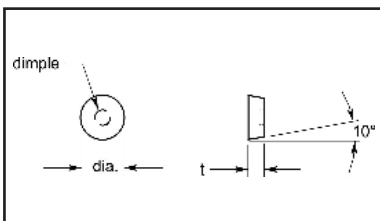

Part No.	Dimensional Specifications		
	t	dia.	dimple
RPR32-DIMPLE	.135/.143	.389/.395	.137/.138

1000 Series

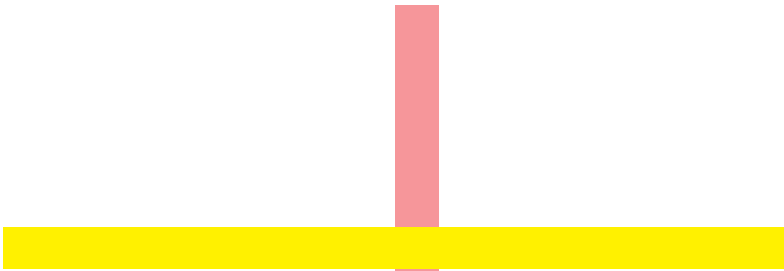

Diamond Negative



TURNING

MILLING

GROOVING

DRILLING

THREADING

BRAZED
BLANKS

RECTANGLES
STB

WOOD
WORKING

OIL & GAS
MINING

MISC.
SHAPES

TURNING

MILLING

GROOVING

DRILLING

THREADING

BRAZED
BLANKS

RECTANGLES
STB

WOOD
WORKING

OIL & GAS
MINING

MISC.
SHAPES

1000 Series

TURNING

MILLING

GROOVING

DRILLING

THREADING

**BRAZED
BLANKS**

**RECTANGLES
STB**

**WOOD
WORKING**

**OIL & GAS
MINING**

**MISC.
SHAPES**

TURNING

MILLING

GROOVING

DRILLING

THREADING

**BRAZED
BLANKS**

**RECTANGLES
STB**

**WOOD
WORKING**

**OIL & GAS
MINING**

**MISC.
SHAPES**

1000 Series

TURNING

MILLING

GROOVING

DRILLING

THREADING

**BRAZED
BLANKS**

**RECTANGLES
STB**

**WOOD
WORKING**

**OIL & GAS
MINING**

**MISC.
SHAPES**

TURNING

MILLING

GROOVING

DRILLING

THREADING

**BRAZED
BLANKS**

**RECTANGLES
STB**

**WOOD
WORKING**

**OIL & GAS
MINING**

**MISC.
SHAPES**

1000 Series

TURNING

MILLING

GROOVING

DRILLING

THREADING

**BRAZED
BLANKS**

**RECTANGLES
STB**

**WOOD
WORKING**

**OIL & GAS
MINING**

**MISC.
SHAPES**

TURNING

MILLING

GROOVING

DRILLING

THREADING

**BRAZED
BLANKS**

**RECTANGLES
STB**

**WOOD
WORKING**

**OIL & GAS
MINING**

**MISC.
SHAPES**